



○ Luxury expedition yacht ○

Luxury expedition Yacht

Groupe Maritime Verreault Inc.





DRAWINGS & TECHNICAL INFORMATION





Luxury expedition yacht

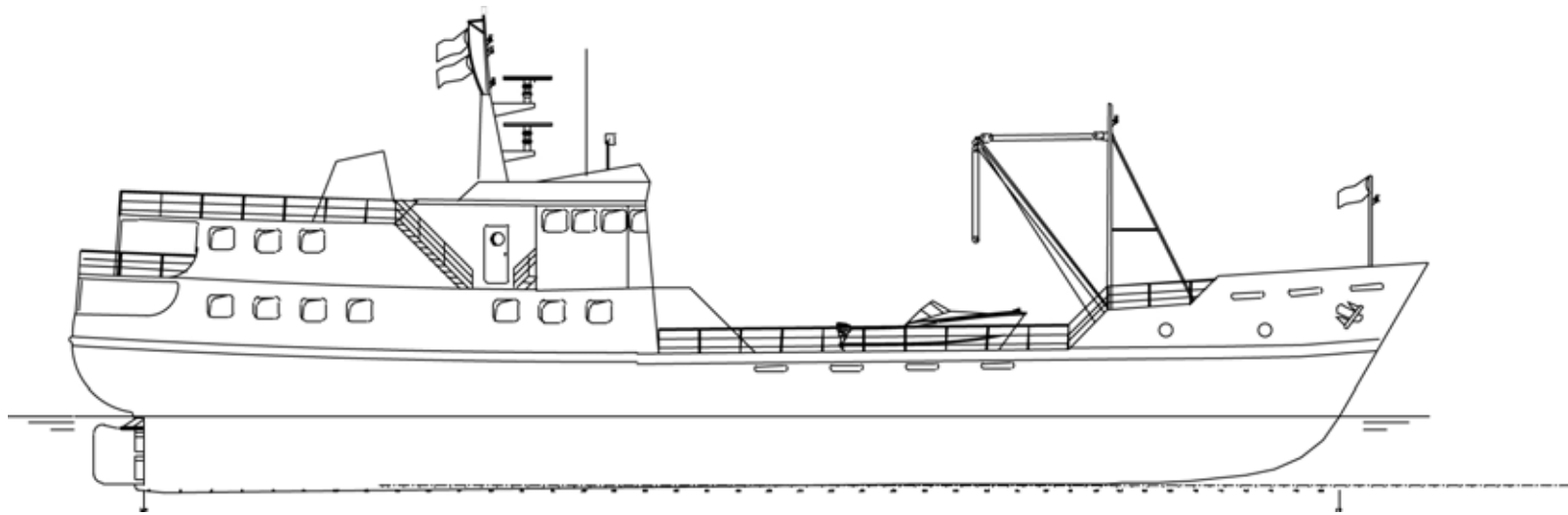

Le Montmagny Today





○ Luxury expedition yacht ○



Le *CCGS Montmagny* at sea





Luxury expedition yacht

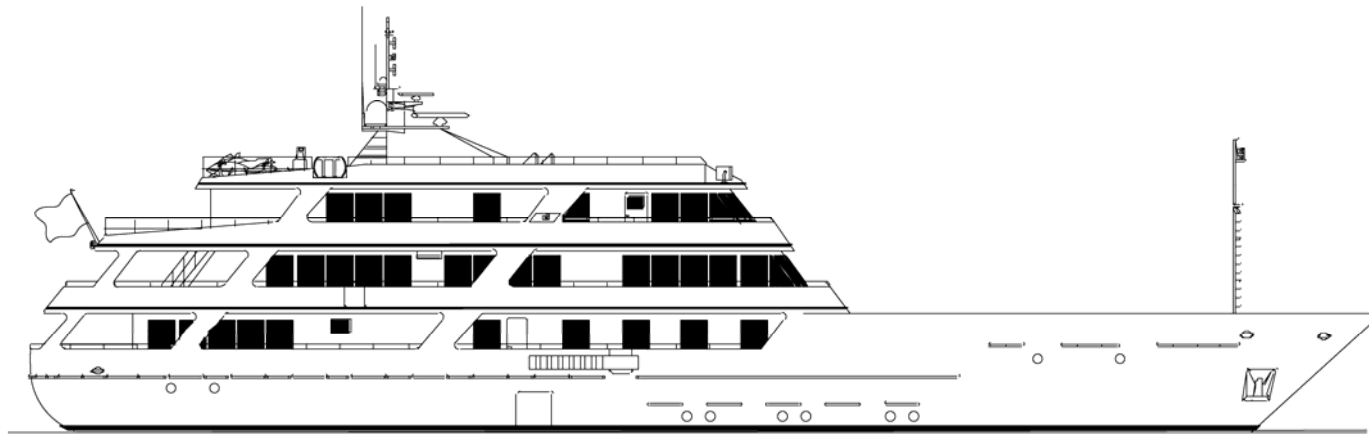

LUXURY EXPEDITION YACHT
AFTER CONVERSION





○ Luxury expedition yacht

Conceptual Drawing - Profile



LUXURY EXPEDITION YACHT
AFTER CONVERSION





○ Luxury expedition yacht ○

Conceptual Drawing - Aerial View



LUXURY EXPEDITION YACHT
AFTER CONVERSION





Transformation of a vessel into a Luxury expedition yacht

- formerly a Canadian Coast Guard vessel
- Superior workmanship in construction of vessel
- Vessel is equipped to operate in northern waters and icy conditions





Vessel Specifications

Name:	Montmagny
Vessel Type:	Lighthouse supply and buoy vessel
Builder:	Russel Brothers, Owen Sound, Ontario
Year of Construction:	1963
Hull:	Steel
Official Number:	318536
Port of Registration:	Québec
Class:	Coastal , class II
Ice Class:	Reinforced
Length Overall :	45.11 m
Length between perps.:	41.15 m
Breadth:	8.84 m
Depth:	3.10 m
Summer Load Line:	972 mm
Average Draft:	2.69 m
Maximum Draft:	3.40 m
Cruising Speed:	11 Knots
Horse Power:	782 kw
Propellers (2)- diameter:	1.65 m
- fixed pitch:	1.30 m





Vessel Specifications (continued)

Gross tonnage:	497 tonnes
Net tonnage:	195 tonnes
Displacement Lightship:	475 tonnes
Displacement with Cargo:	615 tonnes
Deadweight:	140 tonnes
Maximum Cargo Capacity:	100 tonnes
Fuel capacity:	55 000 litres
Cruising distance:	4000 nautical miles
Fuel Consumption:	115 litres/hour
crew:	11 person





Mechanical information

Principal Engine:	2 x Stork Werkspoor TMAS-278, 8 cylinders
Propulsion:	Diesel direct drive
Power:	782 Kw
Generators:	3 x Cummins NH-250 @ 75 Kw





Vessel Profile

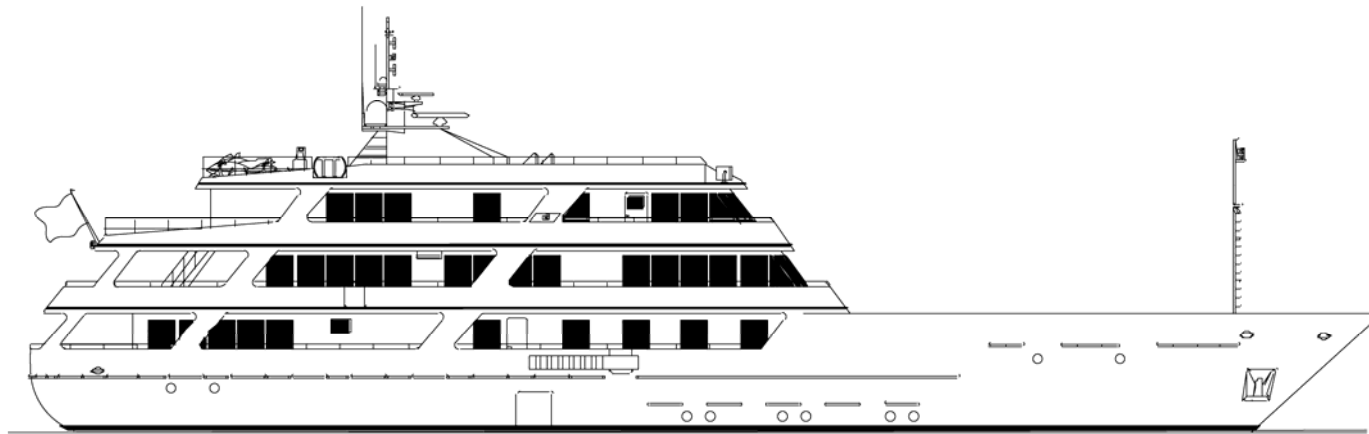



Sun Deck

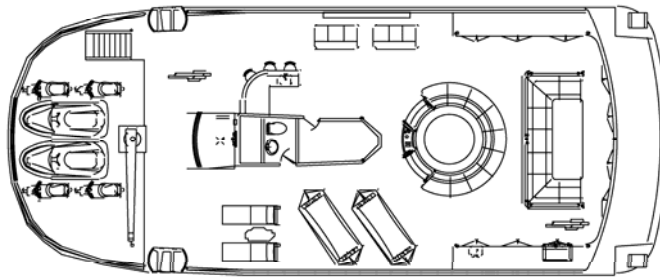



Sun Deck

- Passenger Seating and Bar
- Jacuzzi
- Washroom
- Seadoo/Scooter Storage





Bridge Deck

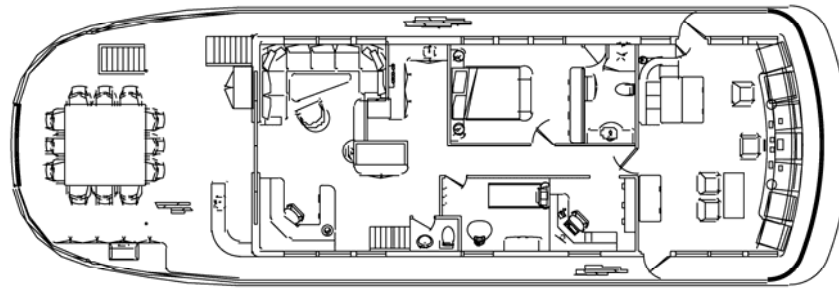



Bridge Deck

- Wheel house and Navigation Deck
- Captain's Accommodations
- Office
- Bar-B.Q. and Bar





Upper Deck

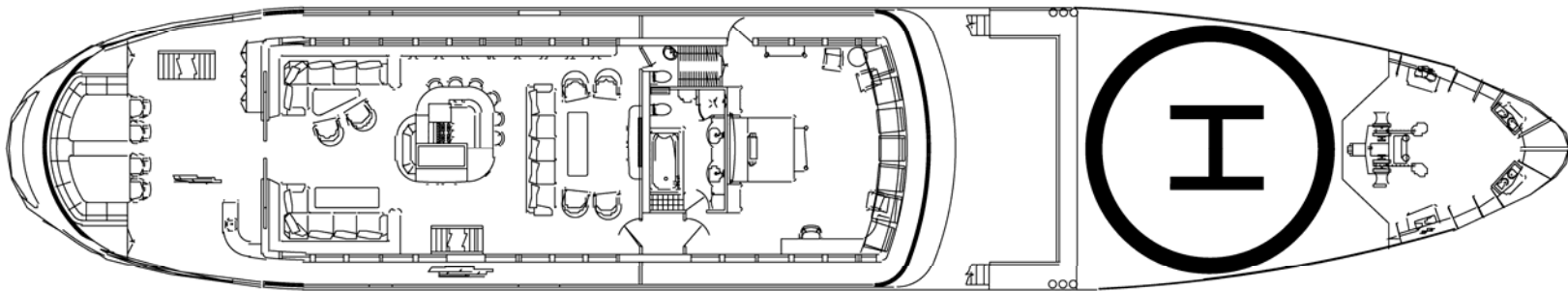



Upper Deck

- Helipad
- Master Cabin
- Lounge
- Exterior Dining Room





Main Deck

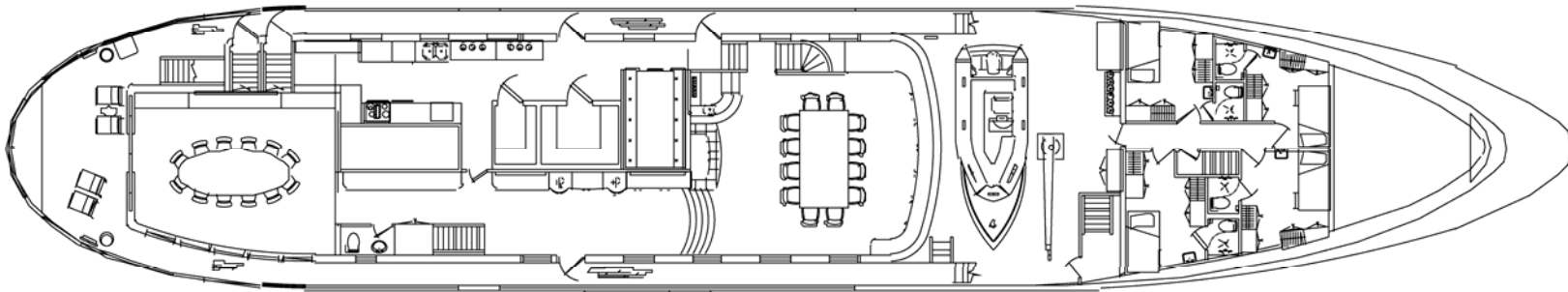



Main Deck

Fore

- Crew Accommodations
- Zodiac Storage

Aft

- Conference Room / Movie Room / Library
- Kitchen
- Dining Room





Lower Deck

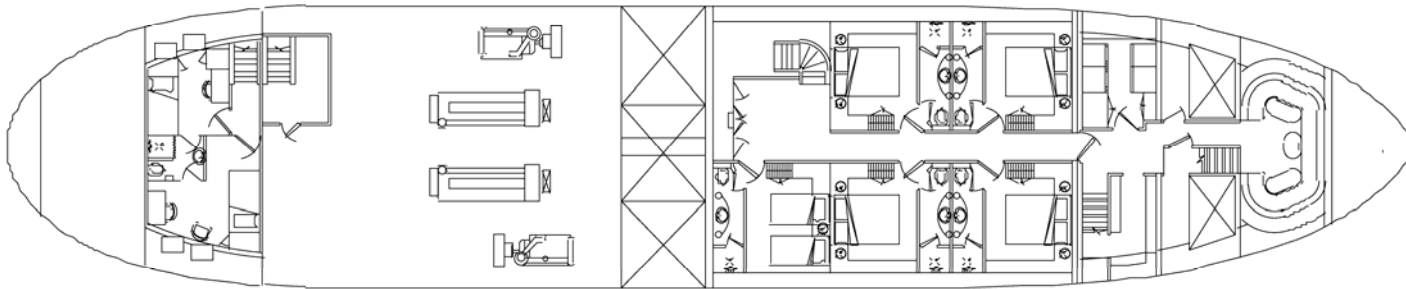



Lower Deck

Fore

- Storage
- Accommodations for passengers (5 Cabins)

Aft

- Engine Room
- Crew Accommodations

